

KENOSHA COUNTY BOARD OF SUPERVISORS

RESOLUTION NO.

Subject: PROBATIONARY CABARET LICENSE – STEIN FARMS, LLC.
--

Original <input checked="" type="checkbox"/>	Corrected <input type="checkbox"/>	2 nd Correction <input type="checkbox"/>	Resubmitted <input type="checkbox"/>
Date Submitted: July 7, 2020		Date Resubmitted:	
Submitted By: Judiciary & Law Enforcement Committee			
Fiscal Note Attached: <input type="checkbox"/>		Legal Note Attached: <input type="checkbox"/>	
Prepared By: Robert Hallisy, Jr. Captain of Operations		Signature:	

WHEREAS, the application of **Clem Stein** for a probationary cabaret license for **Stein Farms, 5708 312th Ave. Salem**, Wisconsin, in the Town of **Wheatland**, was made during the month of **June of 2020**, was turned over to the Kenosha Sheriff's Office on **June 17, 2020**, and,

WHEREAS, said applicant has paid to the Kenosha County Treasurer's Office the application fee of \$200.00, and

WHEREAS, the Kenosha Sheriff's Department has conducted an inspection of the premises, and

WHEREAS, the premises were found to be in conformity with the Cabaret Ordinance Number 8.02.

NOW, THEREFORE BE IT RESOLVED, that because this is the initial application by the license holder, a probationary license be granted to **Clem Stein of Stein Farms** for **six months**.

Respectfully Submitted,

JUDICIARY AND LAW ENFORCEMENT COMMITTEE

	<u>Aye</u>	<u>No</u>	<u>Abstain</u>	<u>Excused</u>
_____ Supervisor Boyd Frederick, Chairperson	<input type="checkbox"/>	<input type="checkbox"/>	<input type="checkbox"/>	<input type="checkbox"/>
_____ Supervisor David Celebre, Vice Chairperson	<input type="checkbox"/>	<input type="checkbox"/>	<input type="checkbox"/>	<input type="checkbox"/>
_____ Supervisor Jeff Wamboldt	<input type="checkbox"/>	<input type="checkbox"/>	<input type="checkbox"/>	<input type="checkbox"/>
_____ Supervisor Mark Nordigan	<input type="checkbox"/>	<input type="checkbox"/>	<input type="checkbox"/>	<input type="checkbox"/>
_____ Supervisor Laura Belsky	<input type="checkbox"/>	<input type="checkbox"/>	<input type="checkbox"/>	<input type="checkbox"/>
_____ Supervisor Sharon Pomaville	<input type="checkbox"/>	<input type="checkbox"/>	<input type="checkbox"/>	<input type="checkbox"/>
_____ Supervisor Jerry Gulley	<input type="checkbox"/>	<input type="checkbox"/>	<input type="checkbox"/>	<input type="checkbox"/>



KENOSHA SHERIFF

FIELD CASE REPORT

CASE# 2019-00325599

EVENT	REPORTED DATE/TIME 06/18/2020 10:24	OCCURRED INCIDENT TYPE	
	OCCURRED FROM DATE/TIME	OCCURRED THRU DATE/TIME	LOCATION OF OCCURRENCE

OFFENSES	STATUS/DESCRIPTION	COUILTS	ATTEMPT/COMMIT

SUBJECT	JACKET/SUBJECT TYPE	NAME (LAST, FIRST, MIDDLE, SUFFIX)				
	DOB	AGE or AGE RANGE	ADDRESS (STREET, CITY, STATE, ZIP)			
	RACE	SEX	HEIGHT or RANGE	WEIGHT or RANGE	HAIR	EYE
	IDENTIFICATION TYPE	PRIMARY PHONE		PHONE #2	PHONE #3	

SUBJECT	JACKET/SUBJECT TYPE	NAME (LAST, FIRST, MIDDLE, SUFFIX)				
	DOB	AGE or AGE RANGE	ADDRESS (STREET, CITY, STATE, ZIP)			
	RACE	SEX	HEIGHT or RANGE	WEIGHT or RANGE	HAIR	EYE
	IDENTIFICATION TYPE	PRIMARY PHONE		PHONE #2	PHONE #3	

SUBJECT	JACKET/SUBJECT TYPE	NAME (LAST, FIRST, MIDDLE, SUFFIX)				
	DOB	AGE or AGE RANGE	ADDRESS (STREET, CITY, STATE, ZIP)			
	RACE	SEX	HEIGHT or RANGE	WEIGHT or RANGE	HAIR	EYE
	IDENTIFICATION TYPE	PRIMARY PHONE		PHONE #2	PHONE #3	

PREPARED BY Zoerner David 206	DATE 06/18/2020	RECEIVED BY Malecki, Mark M	06/18/2020
----------------------------------	--------------------	--------------------------------	------------



Kenosha County Sheriff's Department

Summary

Print Date/Time: 06/18/2020 07:09
 Login ID: kcad\rhallisy
 Case Number: 2019-00325599

Kenosha County Sheriff's Department
 ORI Number: WI0300000

Case

Case Number: 2019-00325599
 Location: 5708 312TH AVE
 BURLINGTON, WI 53168
 Reporting Officer ID: 206 - Zoerner

Incident Type: Service
 Occurred From: 06/12/2019 15:42
 Occurred Thru: 06/12/2019 15:42
 Disposition:
 Disposition Date:
 Reported Date: 06/12/2019 15:42 Wednesday

Offenses

No.	Group/ORI	Crime Code	Statute	Description	Counts

Property

Date	Code	Type	Make	Model	Description	Tag No.	Item No.

Routing:



KENOSHA SHERIFF
FIELD CASE REPORT

CASE# 2019-00325599

NARRATIVE

I, Sgt. David Zoerner, responded to Stein Farms at 5708 312th Avenue reference following up on a Cabaret License Check that I conducted on 06-12-2019.

The structures and layout of the venue remain unchanged from my previous inspection. See attached diagram.

Stein Farms is not currently in possession of a valid Class B Liquor License, as it is to be voted upon by the Town of Wheatland Board at the town meeting Monday, June 22, 2020, per Wheatland Town Clerk, Shiela Siegler. Clerk Siegler advised that she will forward the Class B Liquor License as soon as it is available. No problems with its issuance are foreseen.

Nothing further at this time.

REPORTING OFFICER:
Zoerner David 206

06/18/2020

REPORTING OFFICER:
Malecki, Mark M

06/18/2020

APPLICATION FOR PROBATIONARY CABARET LICENSE

Kenosha County, Wisconsin

DATE: 6-9-20



TO THE KENOSHA COUNTY BOARD OF SUPERVISORS:

I, as holder of a Class B Liquor License, hereby apply for a Probationary Cabaret License for:

Stein Farms 5708 312th Ave. Salem, WI. 53168
Name of Premises Address

5708 312th Ave. Salem, WI. 53168
Mailing Address Zip Code

Located in the Town of Wheatland, in the County of Kenosha from the date hereof for **6 months**, (an application for a regular cabaret license will be sent upon expiration of the probationary license) and I hereby agree to deposit **\$200.00** for said license and to comply with all the provisions of the Cabaret License Ordinance adopted by the County Board and in effect March 6, 2001 and all the laws of the State of Wisconsin pertaining thereto.

Clem Steis
PRINT LICENSE HOLDER'S NAME

Cl Steis
Signature of Applicant (Must be license holder)

312-371-1155
Day-time Telephone Number

A PHOTOCOPY OF YOUR CLASS B LIQUOR LICENSE MUST BE SUBMITTED WITH THIS APPLICATION

NOTE: AN UPDATED LIQUOR LICENSE MUST BE FILED WITH THE CLERK'S OFFICE FOLLOWING RENEWAL IN JULY

TOWN OF WHEATLAND

34315 Geneva Road · P.O. Box 797 · New Munster, Wisconsin 53152-0797 · Phone: (262) 537-4340 · Fax (262) 537-4261

CERTIFICATE OF OCCUPANCY

Parcel No.: 95-4-219-364-012
Location: 5708-31/2nd AVE.
Owner(s): STEIN FARMS
Type of structure: A-2 BANQUET HALL
Current use: SAME

After final inspection of the structure located on the above-described parcel, I hereby certify that it has been built according to the codes of the Town of Wheatland and the State of Wisconsin, with the following exceptions, and may be occupied as listed.

Any future use of the structure must conform with uses allowed for this zoning district as delineated in the Kenosha County Shoreland and Floodplain Zoning Ordinance.

Wheatland Building Inspector

Certificate No. 70246

EXCEPTIONS: _____

After the above exceptions are completed, another inspection must be made and a clear certificate issued.

DATED: 5/17/09 Recd. 5/21/09

KENOSHA COUNTY
 Treasurer
 1010 56th Street
 Kenosha, WI 53140

003050-0007 Jeslyn S. 06/16/2020 02:52PM

COUNTY CLERK

CL23 Cabaret License-Probationary 1 @ 200.00
 CL23 Cabaret License-Probationary 200.00
 100-150-1510-444010-- 200.00C

 200.00

Subtotal 200.00
 Total 200.00

CHECK 200.00
 Check Number 3010

Change due -----
 0.00

Paid by: The Stein Farms

Comments: Cabaret License Prob - Stein Farms

FOR CHECK PAYMENTS, RECEIPT IS NOT VALID
 UNTIL THE CHECK HAS CLEARED ALL BANKS.

CUSTOMER COPY
 DUPLICATE RECEIPT

ENDORSE HERE

PAY TO THE ORDER OF
 Johnson Bank 075911852
 FOR DEPOSIT ONLY
 KENOSHA COUNTY
 122006822
 003050-000007 06/16/2020 02:51PM
 200.00
 KCAB

79-1784759 3010

DATE 6-10-20

PAY TO THE ORDER OF Kenosha County Treasurer \$ 200.00 DOLLARS

Two Hundred

TOWN BANK
 A WINTRUST COMMUNITY BANK

THE STEIN FARMS
 CLEMENT STEIN III
 5708 312TH AVE
 SALEM, WI 53168-9229

MP

9 784310000 20669 3010

COMBINATION
FORM

No. 2019/2020 -- 009

CLASS B RETAILER'S LICENSE
for the sale of
FERMENTED MALT BEVERAGES and INTOXICATING LIQUORS

WHEREAS, the local governing body of the **TOWN of WHEATLAND**, County of **KENOSHA**, Wisconsin, has, upon application duly made, granted and authorized the issuance of a Retail Class "B" License to **Stein Farms LLC, Clem Stein, Agent** to sell Fermented Malt Beverages as defined by and pursuant to Section 125.26 of the Statutes of the State of Wisconsin and Local Ordinances and the said applicant has paid to the Treasurer the sum of **\$100.00** for such Class "B" Retailer's Fermented Malt Beverage license as required by local ordinances,

AND WHEREAS, the local governing body has granted and authorized the issuance of a "Class B" Intoxicating Liquor License to said applicant to sell intoxicating liquor as defined in and pursuant to Chapter 125.51(3) of the Statutes of the State of Wisconsin and local ordinances and the said applicant has paid to the Treasurer the sum of **\$200.00** for such "Class B" Intoxicating Liquor License as provided by local ordinances and has complied with all the requirements necessary for obtaining such licenses,

LICENSES ARE HEREBY ISSUED to said applicant to sell, deal and traffic in, at retail, Fermented Malt Beverages and Intoxicating Liquors at the following described premises **"Stein Farms" 5708 312th Ave, events barn, stage, beer garden, patio, breezeway, lodge, and courtyard per attached map.**

FOR THE PERIOD from July 1, 2019 thru June 30, 2020.

Given under my hand and the corporate seal of the

TOWN of WHEATLAND

this twenty-fourth day of June 2019

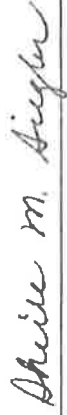

Sheila M. Siegler, Town Clerk



WISCONSIN DEPARTMENT OF REVENUE
PO BOX 8902
MADISON, WI 53708-8902

Contact Information:

2135 RIMROCK RD PO BOX 8902
MADISON, WI 53708-8902
ph: 608-265-2776 fax: 608-264-6884
email: DORBusinessTax@wisconsin.gov
website: revenue.wi.gov

Letter ID L0635431312

CLEM STEIN
STEIN FARMS LLC
5708 312TH AVE.
SALEM WI 53168-9229

Wisconsin Department of Revenue Seller's Permit

Legal/real name: STEIN FARMS LLC
Business name: STEIN FARMS LLC
5708 312TH AVE.
SALEM WI 53168-9229

- This certificate confirms you are registered with the Wisconsin Department of Revenue and authorized in the business of selling tangible personal property and taxable services.
- You may not transfer this permit.
- This permit must be displayed at the place of business and is not valid at any other location.
- If your business is not operated from a fixed location, you must carry or display this permit at all events.

<u>Tax Type</u>	<u>Account Type</u>	<u>Account Number</u>
Sales & Use Tax	Seller's Permit	456-1029951372-02

Sec. 183.0202
Wis. Stats.



State of Wisconsin
Department of Financial Institutions

ARTICLES OF ORGANIZATION - LIMITED LIABILITY COMPANY

Executed by the undersigned for the purpose of forming a Wisconsin Limited Liability Company under Chapter 183 of the Wisconsin Statutes:

Article 1. **Name of the limited liability company:**
Stein Farms LLC

Article 2. **The limited liability company is organized under Ch. 183 of the Wisconsin Statutes.**

Article 3. **Name of the initial registered agent:**
LEGALINC CORPORATE SERVICES INC.

Article 4. **Street address of the initial registered office:**
4650 WEST SPENCER STREET
SUITE L
APPLETON, WI 54914
United States of America

Article 5. **Management of the limited liability company shall be vested in:**
A member or members

Article 6. **Name and complete address of each organizer:**
Clem Stein
5708 312th Ave.
Salem, WI 53168
United States of America

Other Information. **This document was drafted by:**
Zoe Dickson

Organizer Signature:
Clem Stein

Date & Time of Receipt:
5/30/2017 2:35:46 PM

**DEPARTMENT OF THE TREASURY
ALCOHOL AND TOBACCO TAX AND TRADE BUREAU (TTB)
Alcohol Dealer Registration – For Use On and After July 1, 2008**
(Please read instructions carefully before completing this form)

SECTION 1 – IDENTIFYING INFORMATION
Complete all fields in section 1 to correctly identify your business

NAME (Last, First, Middle) or CORPORATE NAME (If Corporation) STEIN FARMS LLC		EMPLOYER IDENTIFICATION NUMBER (See Instructions) -82-1694879	
MAILING ADDRESS (Street address or P.O. Box) 5708 312TH AVE.	CITY SALEM	STATE WI	ZIP CODE 53168

SELECT BOX a, b, or c:

a. NEW BUSINESS

b. OUT OF BUSINESS

c. EXISTING BUSINESS WITH CHANGE IN: (complete items below)

<input type="checkbox"/> NAME / TRADE NAME	<input type="checkbox"/> OWNERSHIP INFO
<input type="checkbox"/> ADDRESS / LOCATION	<input type="checkbox"/> EMPLOYER IDENTIFICATION NUMBER
<input type="checkbox"/> BUSINESS CLASS (OLD: -)	
<input type="checkbox"/> PHONE (NEW: -)	

DATE OF CHANGE, OR OF ENTRY INTO BUSINESS, OR OF TERMINATION OF BUSINESS (mm/dd/yyyy)

SECTION 2 – BUSINESS CLASS(ES) AND PREMISES LOCATIONS
Enter information below for each business location, using the appropriate class code

DEALER CLASS	SUBCLASS	CLASS CODE
RETAIL DEALER (Anyone who sells, or offers for sale, beverage alcohol products to any person other than a dealer. Examples are package stores, restaurants, bars, private clubs, fraternal organizations, grocery stores or supermarkets which sell such beverages.)	Liquors (Distilled Spirits, Wine or Beer)	11
	Beer Only	12
	Liquors (Distilled Spirits, Wine or Beer) – At Large*	15
	Beer Only – At Large*	16
WHOLESALE DEALER (Anyone who sells, or offers for sale, beverage alcohol products to another dealer. An IMPORTER must register as a wholesaler if he or she sells beverage alcohol products to other dealers.)	Liquors (Distilled Spirits, Wine, or Beer)	31
	Beer Only	32

* A retail dealer at large is one whose business requires him to move from place to place, such as a circus or carnival.

CLASS CODE	TRADE NAME	PREMISES ADDRESS STREET NUMBER AND NAME	CITY, STATE, ZIP CODE	TELEPHONE NUMBER
11	STEIN FARMS	5708 312TH AVE.	SALEM, WI. 53168	(312) 371-1155
				()
				()
				()
				()

Under penalties of perjury, I declare that the statements in this registration are true and correct to the best of my knowledge and belief; that this registration applies only to the specified business and location or, where the registration is for more than one location, it applies only to the businesses at the locations specified on the attached list.

SIGNATURE 	TITLE PRESIDENT/MANAGER	DATE 03/14/2019
---------------	-----------------------------------	---------------------------

Date of this notice: 05-30-2017

Employer Identification Number:
82-1694879

Form: SS-4

Number of this notice: CP 575 G

STEIN FARMS LLC
CLEM STEIN SOLE MBR
5708 312TH AVE
SALEM, WI 53168

For assistance you may call us at:
1-800-829-4933

IF YOU WRITE, ATTACH THE
STUB AT THE END OF THIS NOTICE.

WE ASSIGNED YOU AN EMPLOYER IDENTIFICATION NUMBER

Thank you for applying for an Employer Identification Number (EIN). We assigned you EIN 82-1694879. This EIN will identify you, your business accounts, tax returns, and documents, even if you have no employees. Please keep this notice in your permanent records.

When filing tax documents, payments, and related correspondence, it is very important that you use your EIN and complete name and address exactly as shown above. Any variation may cause a delay in processing, result in incorrect information in your account, or even cause you to be assigned more than one EIN. If the information is not correct as shown above, please make the correction using the attached tear off stub and return it to us.

A limited liability company (LLC) may file Form 8832, *Entity Classification Election*, and elect to be classified as an association taxable as a corporation. If the LLC is eligible to be treated as a corporation that meets certain tests and it will be electing S corporation status, it must timely file Form 2553, *Election by a Small Business Corporation*. The LLC will be treated as a corporation as of the effective date of the S corporation election and does not need to file Form 8832.

To obtain tax forms and publications, including those referenced in this notice, visit our Web site at www.irs.gov. If you do not have access to the Internet, call 1-800-829-3676 (TTY/TDD 1-800-829-4055) or visit your local IRS office.

IMPORTANT REMINDERS:

- * Keep a copy of this notice in your permanent records. This notice is issued only one time and the IRS will not be able to generate a duplicate copy for you. You may give a copy of this document to anyone asking for proof of your EIN.
- * Use this EIN and your name exactly as they appear at the top of this notice on all your federal tax forms.
- * Refer to this EIN on your tax-related correspondence and documents.

If you have questions about your EIN, you can call us at the phone number or write to us at the address shown at the top of this notice. If you write, please tear off the stub at the bottom of this notice and send it along with your letter. If you do not need to write us, do not complete and return the stub.

Your name control associated with this EIN is STEI. You will need to provide this information along with your EIN, if you file your returns electronically.

Thank you for your cooperation.

KJS\crm406



KENOSHA SHERIFF
FIELD CASE SUPPLEMENT

CASE# 2019-00325599

SUPPLEMENTAL NARRATIVE

On 07/29/2019, I, Sgt. David Zoerner received notification from Town of Wheatland Clerk Sheila Siegler reference the Stein Farms Cabaret License Check final inspection. Clerk Siegler advised that the Stein Farm has not received "a final sign off," but with extenuating circumstances.

Stein Farms has received approval from the state of the revised fire suppression plans for the building. The fire suppression system has been installed and last Friday it did pass a pressure test of the system. But, to receive a final signoff, the test must be performed in the presence of the building inspector and fire chief by an independent testing firm. Neither of those two officials were available on Friday. So, a date has been set up for mid-August. At that time, there should be a final to this.

Clerk Seigler advises that she will advise the Sheriff's Office of the outcome of that final inspection.

Nothing Further

REPORTING OFFICER 206 Zoerner	DATE 07/29/2019	REVIEWED BY Zoerner, David W	07/29/2019
---	---------------------------	--	-------------------



KENOSHA SHERIFF
FIELD CASE REPORT

CASE# 2019-00325599

EVENT	REPORTED DATE/TIME 06/12/2019 15:42	OCCURRED INCIDENT TYPE Service	
	OCCURRED FROM DATE/TIME 06/12/2019 15:42	OCCURRED THRU DATE/TIME 06/12/2019 15:42	LOCATION OF OCCURRENCE STEIN FARMS LLC 5708 312 AVE

OFFENSES	STATUTE/DESCRIPTION	COUNTS	ATTEMPT/COMMIT	

SUBJECT	JACKET/SUBJECT TYPE Adult Other	NAME (LAST FIRST MIDDLE SUFFIX) Stein, Clement					
	DOB 09/30/1960	AGE or AGE RANGE 58	ADDRESS (STREET, CITY, STATE, ZIP) 5700 312 AVE Salem, WI 53168				
	RACE White	SEX Male	HEIGHT or RANGE 6'0 6'0	WEIGHT or RANGE 170 170	HAIR Brown	EYE Blue	
	IDENTIFICATION TYPE Photo Drivers License	PRIMARY PHONE (312)371-1155	PHONE #2	PHONE #3			

SUBJECT	JACKET/SUBJECT TYPE	NAME (LAST FIRST MIDDLE SUFFIX)					
	DOB	AGE or AGE RANGE	ADDRESS (STREET, CITY, STATE, ZIP)				
	RACE	SEX	HEIGHT or RANGE	WEIGHT or RANGE	HAIR	EYE	
	IDENTIFICATION TYPE	PRIMARY PHONE	PHONE #2	PHONE #3			

SUBJECT	JACKET/SUBJECT TYPE	NAME (LAST FIRST MIDDLE SUFFIX)					
	DOB	AGE or AGE RANGE	ADDRESS (STREET, CITY, STATE, ZIP)				
	RACE	SEX	HEIGHT or RANGE	WEIGHT or RANGE	HAIR	EYE	
	IDENTIFICATION TYPE	PRIMARY PHONE	PHONE #2	PHONE #3			

REPORTING OFFICER 206 ZoernerDavid	DATE 06/12/2019	REVIEWED BY Zoerner, David W	06/13/2019
--	---------------------------	--	-------------------



KENOSHA SHERIFF
FIELD CASE REPORT

CASE# 2019-00325599

NARRATIVE

On 06-12-2019 at 1542 hours, Sergeant David Zoerner conducted a Probationary Cabaret License Application Check at Stein Farms, 5708 312th Avenue. I met with owner Clem Stein in the north building at the bar area. I observed their Class B Retailer's License issued by the Town of Wheatland on May 13, 2019 clearly displayed on the west wall at the bar area. Expires June 30, 2019. Also clearly displayed was the Temporary Cabaret License for an event held there on June 8, 2019. Mr. Stein also presented me with three additional Temporary Cabaret Licenses for upcoming events. These are dated for June 16, 2019, June 23, 2019 and June 30, 2019. I gave Clem Stein a printed copy of the Kenosha County Ordinance 8.02 Cabaret Licenses.

The Stein Farms venue is two separate buildings. The north building contains a dance area with a small stage in the northeast corner, bar and kitchen area. The building to the south contains seating area for dinner service, also can be used as a dancing area, per Clem Stein. There is an outdoor seating area to the east of these buildings. The north side of the property contains the parking area including clearly marked handicap accessible parking stalls directly in front of the north building and outdoor seating area.

Stein Farms has had issues with its fire suppression system and does not have a final inspection completed by the state at this time. I spoke with Shiela Siegler, Clerk for the Town of Wheatland reference the inspection for Stein Farms LLC. Clerk Siegler advised that Stein Farms is waiting for a revised state plan approval as there were changes made during the installation of their fire suppression system. Stein Farms cannot receive a final inspection from the Town of Wheatland building inspector until Town of Wheatland has the state approved plan on file.

Clerk Siegler advised that although municipalities can issue business licenses, the Town of Wheatland does not. Siegler provided me with copies of business documentation for Stein Farms LLC including the Wisconsin Department of Revenue Seller's Permit, State of Wisconsin Articles of Incorporation - Limited Liability Company, Alcohol Dealer Registration from the Alcohol and Tobacco Tax and Trade Bureau and their Internal Revenue Service Employer ID number assignment.

REPORTING OFFICER	DATE	REVIEWED BY	
206 ZoernerDavid	06/12/2019	Zoerner, David W	06/13/2019

No. 2018/2019 -- 009

CONSIGNMENT
FORM

CLASS B RETAILER'S LICENSE

for the sale of

FERMENTED MALT BEVERAGES and INTOXICATING LIQUORS

WHEREAS, the local governing body of the **TOWN of WHEATLAND**, County of **KENOSHA**, Wisconsin, has, upon application duly made, granted and authorized the issuance of a Retail Class "B" License to **Stein Farms LLC, Clem Stein, Agent** to sell Fermented Malt Beverages as defined by and pursuant to Section 125.26 of the Statutes of the State of Wisconsin and Local Ordinances and the said applicant has paid to the Treasurer the sum of **\$16.67** for such Class "B" Retailer's Fermented Malt Beverage license as required by local ordinances,

AND WHEREAS, the local governing body has granted and authorized the issuance of a "Class B" Intoxicating Liquor License to said applicant to sell intoxicating liquor as defined in and pursuant to Chapter 125.51(3) of the Statutes of the State of Wisconsin and local ordinances and the said applicant has paid to the Treasurer the sum of **\$33.33** for such "Class B" Intoxicating Liquor License as provided by local ordinances and has complied with all the requirements necessary for obtaining such licenses,

LICENSES ARE HEREBY ISSUED to said applicant to sell, deal and traffic in, at retail, Fermented Malt Beverages and Intoxicating Liquors at the following described premises **"Stein Farms" 5708 312th Ave., events barn, stage, beer garden, patio, breezeway, lodge, and courtyard per attached map.**

FOR THE PERIOD from May 9 thru June 30, 2019.

Given under my hand and the corporate seal of the

TOWN of WHEATLAND

this 13 day of May, 2019

Shirley M. Augler

Stein Farms LLC.
5708 312 Avenue

CTH NN / 312th Avenue

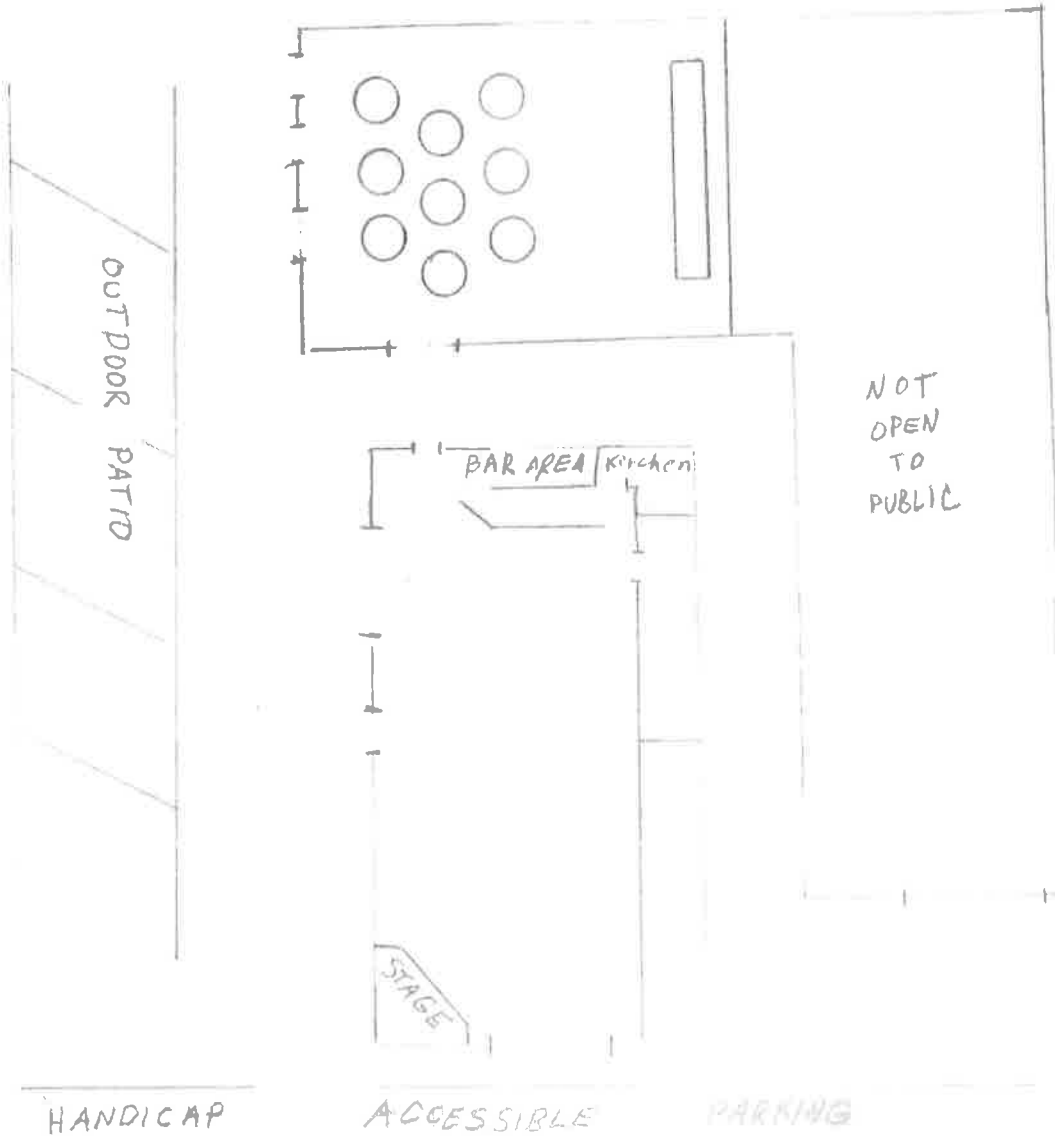

Stein Farms LLC Probationary Cabaret License Application

APPLICATION FOR PROBATIONARY CABARET LICENSE

Kenosha County, Wisconsin

DATE: 4-23-19

TO THE KENOSHA COUNTY BOARD OF SUPERVISORS:

I, as holder of a Class B Liquor License, hereby apply for a Probationary Cabaret License for:

Stein Farms 5708 312th Ave. Salem, WI. 53168
Name of Premises Address

5708 312th Ave. Salem, WI. 53168
Mailing Address Zip Code

Located in the Town of Wheatland, in the County of Kenosha, from the date hereof for **6 months**, (an application for a regular cabaret license will be sent upon expiration of the probationary license) and I hereby agree to deposit **\$200.00** for said license and to comply with all the provisions of the Cabaret License Ordinance adopted by the County Board and in effect March 6, 2001 and all the laws of the State of Wisconsin pertaining thereto.

Clem Stein
PRINT LICENSE HOLDER'S NAME

[Signature]
Signature of Applicant (Must be license holder)

312-376-1155
Day-time Telephone Number

A PHOTOCOPY OF YOUR CLASS B LIQUOR LICENSE MUST BE SUBMITTED WITH THIS APPLICATION

NOTE: AN UPDATED LIQUOR LICENSE MUST BE FILED WITH THE CLERK'S OFFICE FOLLOWING RENEWAL IN JULY